

# *robot* *coupe*®

With 15 fruit  
cocktail recipes



**NEW**  
Register  
your product  
on line



## J 80 Ultra • J 100 Ultra

# www.robot-coupe.com

## @ Register your product on line

The screenshot displays the 'robot coupe' website's 'SUPPORT' page. The top navigation bar includes links for 'The company', 'Contact us', 'Restricted Area', and 'Select your country...'. Below this, a secondary menu features 'CATALOGUE', 'SELECTION GUIDE', 'LEAFLETS', 'VIDEOS', 'OUR', and 'SUPPORT' (which is circled). A search bar is located to the right of the 'SUPPORT' link.

The main content area is titled 'SUPPORT' and is divided into two columns. The left column, titled 'Register your product online', contains the following text: 'Thank you for registering online your Robot-Coupe product', 'This should only take a few minutes', and 'To register your product you will need:'. Below this, a list of requirements is provided: '- Product serial number' and '- Purchase date'. At the bottom of this column is a button labeled 'Register my product now' (circled).

The right column, titled 'Access the Robot-Coupe after-sales service', features a preview of the 'robot coupe Authentification' page. This preview shows a login form with fields for 'Identifiant \*' and 'Mot de passe \*', a 'Mot de passe perdu' link, and an 'Email \*' field. It also includes a language selection dropdown and a link to 'Pour nous contacter' with a note to 'utiliser notre formulaire de contact'. At the bottom of this column is a button labeled 'Access the Robot-Coupe after-sales service'.

# robot coupe®

## EU Declaration of Conformity

**Robot-Coupe SNC** declares that the machines identified by their type above, comply with:

- the essential requirements of the following European directives and with the corresponding national regulations :
  - Directive «Machinery» **2006/42/EC**,
  - Directive «Low Voltage» **2014/35/EU**,
  - Directive «Electromagnetic Compatibility» **2014/30/EU**,
  - Directive «Reduction of Hazardous Substances in Electrical Equipment» (RoHS) **2011/65/EU**,
  - Directive «Waste Electrical and Electronic Equipment» (WEEE) **2012/19/EU**,
- regulation (EC) No 1935/2004 «Materials and Articles intended to come into Contact with Food»,
- regulation (EU) No 10/2011 «Plastic Materials and Articles intended to come into contact with Food» and all (EU) regulations amending, correcting and/or rectifying it, and entered into force prior to the date of this declaration, namely to date the (EU) regulations No 321/2011, 1282/2011, 1183/2012, 202/2014, 865/2014, 2015/174, 2016/1416 and 2017/752.
- the provisions of the following harmonized European standards and the standards specifying the safety and hygiene requirements:
  - **EN ISO 12100:2010** Safety of machinery – General principles for design,
  - **EN 60204-1:2006** Safety of machinery – Electrical equipment of machines,
  - **EN 60529** Degrees of protection provided by enclosures (IP Code):
    - IP 55 for the electric controls,
    - IP 34 for the other parts of the machine,
- and according to the category of the apparatus, with the provisions of the following harmonized European standards specifying the safety and hygiene requirements:
  - **EN 454:2015** .....Planetary Mixers,
  - **EN 1678** .....Vegetable Cutting Machines (and Juice Extractors),
  - **EN 12852** .....Food Processors and Blenders,
  - **EN 12853** .....Hand-Held Blenders and Whisks (Power Mixers),
  - **EN 13208** .....Vegetable Peelers,
  - **EN 13621** .....Salad Dryers,
  - **EN 14655** .....Baguette Slicers.

«R015»

Montceau-en-Bourgogne, on June 21, 2017

Alain NODET  
Industrial Director



# SUMMARY

■ **WARRANTY**

■ **IMPORTANT WARNING**

■ **YOU HAVE JUST ACQUIRED  
A CENTRIFUGAL JUICER  
J 80 Ultra • J 100 Ultra**

■ **SWITCHING ON THE MACHINE**

■ **ASSEMBLY J 80 Ultra**

■ **ASSEMBLY J 100 Ultra**

■ **DIFFERENT CONFIGURATIONS**

■ **RECOMMENDATIONS FOR USE**

■ **CLEANING**

■ **TECHNICAL SPECIFICATIONS**

■ **SAFETY**

■ **TROUBLESHOOTING**

■ **STANDARDS**

■ **RECIPES** (page 14)

■ **TECHNICAL DATA**

- Electrical diagram
- Parts diagram
- 39910 basket assembly sheet

# ROBOT-COUPE S.N.C., LIMITED WARRANTY

**Your new ROBOT-COUPE appliance is warranted to the original buyer for a period of one year from the date of sale if you bought it from ROBOT-COUPE S.N.C.**

**If you bought your ROBOT-COUPE product from a distributor your product is covered by your distributor's warranty (Please check with your distributor terms and conditions of the warranty).**

**The ROBOT-COUPE S.N.C. limited warranty is against defects in material and/or workmanship.**

## **THE FOLLOWING ARE NOT COVERED BY THE ROBOT-COUPE S.N.C. WARRANTY:**

**1** - Damage caused by abuse, misuse, dropping, or other similar damage caused by or resulting from failure to follow assembly, operating, cleaning, user maintenance or storage instructions.

**2** - Labour to sharpen and/ or replacements for blades which have become blunt, chipped or worn after a normal or excessive period of use.

**3** - Materials or labour to replace or repair scratched, stained, chipped, pitted, dented or discoloured surfaces, blades, knives, attachments or accessories.

**4** - Any alteration, addition or repair that has not been carried out by the company or an approved service agency.

**5** - Transportation of the appliance to or from an approved service agency.

**6** - Labour charges to install or test new attachments or accessories (i.e., bowls, discs, blades, attachments) which have been arbitrarily replaced.

**7** - The cost of changing direction-of-rotation of three-phase electric motors (Installer is responsible).

**8** - SHIPPING DAMAGES. Visible and latent defects are the responsibility of the freight carrier. The consignee must inform the carrier and consignor immediately, or upon discovery in the case of latent defects.

**KEEP ALL ORIGINAL CONTAINERS AND PACKING MATERIALS FOR CARRIER INSPECTION.**

Neither ROBOT-COUPE S.N.C. nor its affiliated companies or any of its distributors, directors, agents, employees, or insurers will be liable for indirect damage, losses, or expenses linked to the appliance or the inability to use it.

**The ROBOT-COUPE S.N.C. warranty is given expressly and in lieu of all other warranties, expressed or implied, for merchantability and for fitness toward a particular purpose and constitutes the only warranty made by ROBOT-COUPE S.N.C. France.**

# IMPORTANT WARNING



**WARNING:** In order to limit accidents such as electric shocks or personal injury, and in order to limit material damage due to misuse of the appliance, please read these instructions carefully and follow them strictly. Reading the operating instructions will help you get to know your appliance and enable you to use the equipment correctly. Please read these instructions in their entirety and make sure that anyone else who may use the appliance also reads them beforehand. Our equipment is designed for professional use and must not be used by children under any circumstances.

## UNPACKING

- Carefully remove the appliance from its packaging, together with all the boxes or packets containing the accessories or specific items of equipment.
- **WARNING:** the blades and discs are extremely sharp.

## INSTALLATION

- We recommend that you install your appliance on a clean and completely stable countertop at a comfortable working height.

## CONNECTION

- Always check that your power supply corresponds to that indicated on the serial number plate and that it is properly sized.

## ASSEMBLY PROCEDURES

- Make sure you follow the assembly instructions in the right order (see following pages) and check that all the accessories are correctly positioned.

## USE

- **Never remove the lid until the motor and basket have come to a complete standstill.**

- **Never insert anything other than fruit or vegetables into the feed tube.**
- **The lid of your appliance features a unique Auto Feed system. Simply feed the fruit or vegetables into the tube and let the machine do the rest.**
- **If a blockage occurs inside the feed tube, NEVER use any object other than the pusher to clear it.**
- **Never insert your hand into the ejection chute. If the ejector becomes blocked, switch your J 80 Ultra/J 100 Ultra juicer off and wash the lid under the tap.**
- **Never leave the machine running unattended.**

## CLEANING

- **Always unplug your machine before cleaning.**
- **Always clean the machine and attachments at the end of each use.**
- **Never clean the machine with a pressure washer or foam lance.**
- **Never place the motor unit in water.**
- **Be sure to use the appropriate detergent for each part (stainless steel or plastic).**

- **For plastic parts, do not use detergents that are too alkaline (i.e., containing too much caustic soda or ammonia...).**
- **The bowl, lid and pulp container are all dishwasher-safe. However, to prolong their lifespan, we advise hand-washing them with a domestic washing-up liquid.**
- **Robot Coupe can in no way be held responsible for the user's failure to follow the basic rules of cleaning and maintenance.**

## MAINTENANCE

- **Always unplug the appliance before servicing.**
- **The watertightness of the motor shaft needs to be monitored on a regular basis. At the same time, check that the safety system is working properly.**
- **WARNING: never switch your appliance on if the power cord or plug has been damaged.**
- **If the appliance is not working properly or has been damaged in any way, unplug it and have it overhauled.**
- **Do not hesitate to call your ROBOT-COUPÉ approved after-sales service if you notice a fault.**

## YOU HAVE JUST ACQUIRED A CENTRIFUGAL JUICER J 80 Ultra • J 100 Ultra

Stable and sturdy, the **J 80 Ultra/J 100 Ultra** juicer can produce **any number of 100 % natural juices on demand** and in next to no time!

The **J 80 Ultra/J 100 Ultra** juicer is ideal for making fresh juices from vegetables and locally grown or exotic fruit, as well as sophisticated cocktails, all totally pure and natural.

It therefore has applications in bars, restaurants, canteens, institutions and day nurseries, as well as in healthcare settings and in the production of dietetic foods, where fresh fruit and vegetable juices play a key role.

Fruit and vegetables, especially when they are raw, represent a valuable source of the vitamins, minerals and fibers our bodies need to stay healthy. Vegetable juices contain mainly mineral salts, while fruit juices are packed full of vitamins to boost our energy.

### MINERAL SALTS

Not all foods contain the same mineral salts.

Some minerals, such as potassium, magnesium, sulphur and sodium chloride (salt) are so widespread that a varied diet will always ensure a sufficient intake. For some minerals, however, it is useful to know which are the best sources.

**Calcium** : fruit and green vegetables.

**Phosphorus** : pulses.

**Potassium** : fresh vegetables.

**Iron** : spinach, parsley.

**Iode** : all plants.

### TABLE OF VITAMINS IN FRUIT

Vitamins	B1	C	A	D
Apricot	•	•	•	•
Pineapple	•	•	•	•
Blackcurrant	•	•		•
Cherry	•	•	•	•
Lemon	•	•	•	•
Strawberry	•	•		•
Raspberry	•	•		•
Redcurrant	•	•		•
Kiwi fruit	•	•	•	•
Melon	•	•		•
Blackberry	•	•	•	•
Orange	•	•	•	•
Grapefruit	•	•	•	•
Peach	•	•		•
Pear	•	•		•
Apple	•	•		•
Plum	•	•		•
Grape	•	•		•

### TABLE OF VITAMINS IN VEGETABLES

Vitamines	B1/B6	A	E	K
Asparagus	•		•	
Carrot	•	•	•	
Celery		•	•	•
Celeriac	•			
Cabbage	•	•	•	•
Cucumber	•	•	•	
Courgette	•	•	•	
Watercress	•	•	•	
Chicory	•			
Spinach	•	•	•	•
Fennel	•		•	
Lettuce	•		•	•
Turnip	•			
Onion	•			
Parsley	•	•	•	
Pepper	•	•	•	
Tomato	•	•		

Your appliance's straightforward design means that the parts which most frequently need to be handled for cleaning or aftercare can be removed in no time at all.

To make life even easier for you, these instructions guide you through each of the assembly operations, broken down into simple steps.

These instructions for use contain important information aimed at enabling users to derive the maximum benefit from their juicer.

**We therefore strongly advise you to read through them carefully before you start to use your appliance.**

## SWITCHING ON THE MACHINE

Before connecting your appliance to the mains, check that the voltage of your power supply matches that indicated on your appliance's identification plate.

The **J 80 Ultra/J 100 Ultra** juicer is equipped with a power cord fitted with a standard single-phase plug.

**Check the machine carefully on arrival to ensure that it has not been damaged during transport or unpacking.**

Pay particular attention to the power cord and plug.



### WARNING

**THIS APPLIANCE MUST BE PLUGGED INTO AN EARTHED SOCKET (RISK OF ELECTROCUTION).**



## ASSEMBLY J 80 Ultra

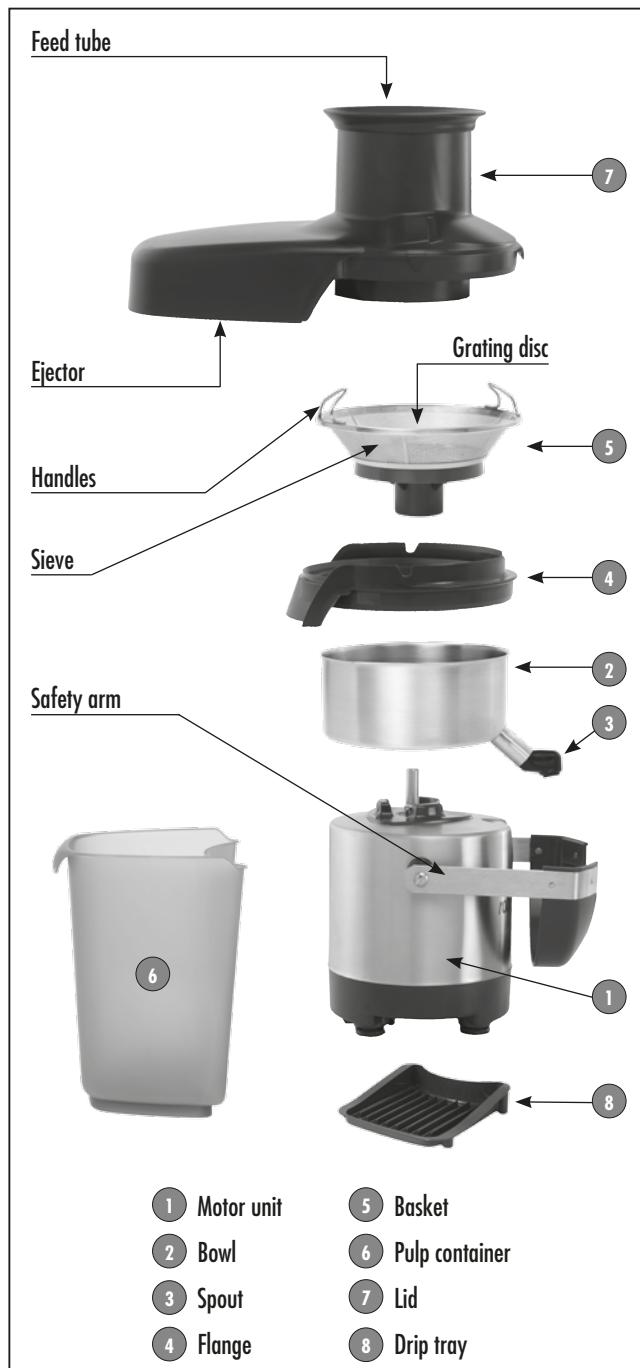

1) Position the motor unit so that the On/Off buttons are facing you.

2) Place the bowl on top of the motor unit.

3) Fit the flange onto the rim of the bowl. The ribs of the flange should be lined up with the flat panel of the bowl. Check that the flange is correctly fitted.



4) Lower the basket into place, holding it by its handles. Rotate it until it slots into place.

5) Line the lid up with the notches in the flange.



### IMPORTANT

Make sure that the pin on the motor shaft is correctly lined up with the corresponding notch in the basket hub.

You can also refer to the label (below) stuck to the lid.

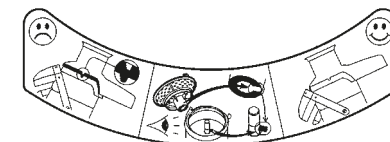





6) Position the **pulp container**.



7) Close the safety arm.

To start the machine, press the On button 1. The juicer will not start unless the safety arm has been closed properly (safety switch).

Place a jug underneath the spout. Your juicer is now ready to go!

## ASSEMBLY J 100 Ultra

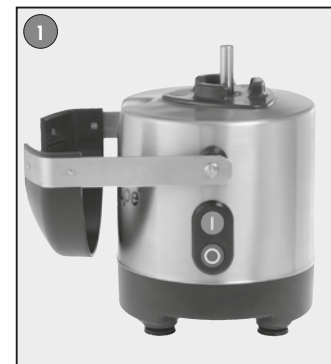

1) Position the motor unit so that the On/Off buttons are facing you.



2) Place the bowl on top of the motor unit.

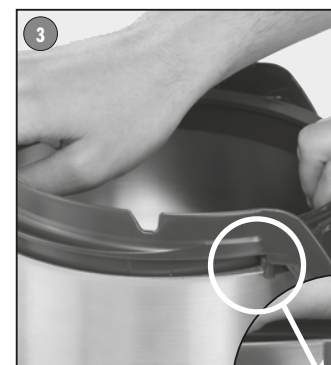

3) Fit the flange onto the rim of the bowl.  
The ribs of the flange should be lined up with the flat panel of the bowl. Check that the flange is correctly fitted.



4) Lower the basket into place, holding it by its handles.

Rotate it until its slots into place.



5) Line the lid up with the notches in the flange



### IMPORTANT

Make sure that the pin on the motor shaft is correctly lined up with the corresponding notch in the basket hub.

You can also refer to the label (below) stuck to the lid.

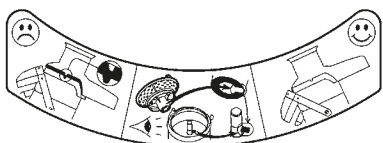

6) Two possible uses:

#### A) Continuous pulp ejection.



Position the continuous **pulp ejection chute** in the hole in the booster base.

Remember to place a bin (not supplied) directly beneath this chute.

For optimum use of the waste discharge hopper flow-through, you can make a hole in your worktop.

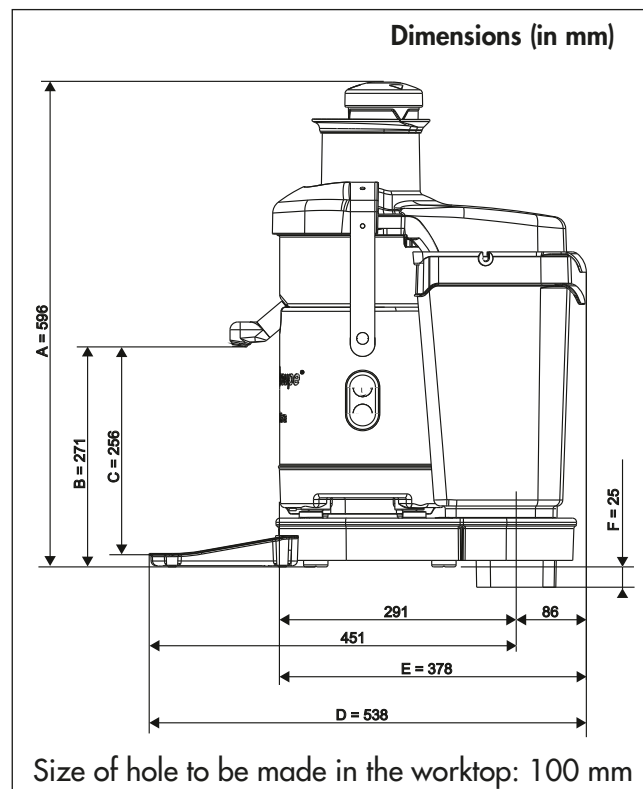

#### B) Ejection of pulp into the closed pulp container.



Position the **pulp container**



7) Close the safety arm.

To start the machine, press the On button 1. The juicer will not start unless the safety arm has been closed properly (safety switch).

Place a jug underneath the spout. Your juicer is now ready to go!

#### 8) Using the strap (see page 8) - (Option)



If you have positioned your juicer on the edge of a countertop, attach the ejection chute to **the lid** using the **strap** supplied with the appliance.

## DIFFERENT CONFIGURATIONS

The **J 100 Ultra** juicer comes supplied with all the accessories you will need and is designed to adapt itself to your particular needs and work setting.

For example, it can be configured to suit the characteristics of your work station:

- Install **the booster base 10** if you are going to use tall containers to collect the juice (see page 8).
- In normal usage, you can process more than ten kilos (according to the nature of the produce) before you need to empty **the pulp container 6** (see page 8).
- For high-volume juicing, **the ejection chute 7** (see page 8) does away with the need to empty the pulp container. If you opt for this configuration, make sure you place a large bin (not supplied) directly below the chute.

There are two solutions for this configuration:







1) Make a **10 cm Ø** hole in the worktop through which **the ejection chute 7** can protrude (see photos opposite). This is the best solution in terms of efficient worktop organization.

2) Worktop edge.

When positioning the machine on the edge of the worktop, use the markers on either side of **the booster base 10** (see page 8) as your guide.

**Warning: to avoid the risk of the machine falling off the worktop, make sure that it is correctly positioned.**

- Summary of all the different possible configurations, according to the nature of the work station and the height of the juice containers (for information only):

Container	Booster base 10 use (see p 8)	Intensity of use	Example of use	
 Containers Max. height 16 cm	Not necessary	Normal	<ul style="list-style-type: none"> <li>• With <b>pulp container 6</b> (see page 8)</li> <li>• No worktop cutout required.</li> </ul>	
		Intensive	<ul style="list-style-type: none"> <li>• With <b>ejection chute 7</b> and <b>strap 9</b> (see page 8)</li> <li>• Worktop edge No cutout required</li> </ul>	
 Containers Max. height 25 cm	Necessary if container more than 16 cm high	Normal	<ul style="list-style-type: none"> <li>• With <b>pulp container 6</b> (see page 8)</li> <li>• No worktop cutout required.</li> </ul>	
		Intensive	<ul style="list-style-type: none"> <li>• With <b>ejection chute 7</b> (see page 8)</li> <li>• Worktop edge No cutout required</li> </ul>	
			<ul style="list-style-type: none"> <li>• With <b>ejection chute 7</b> (see page 8)</li> <li>• Ejection below worktop. <b>10 cm Ø</b> hole required in worktop.</li> </ul>	

## RECOMMENDATIONS FOR USE

### • J 80 Ultra • J 100 Ultra

- Before you use your juicer for the first time, it is a good idea to wash all the parts that will come into contact with food.
- Always check that the **safety arm** has been closed before using your appliance.
- Always place a container under the spout and either **the pulp container** or **the ejection chute** under the ejector after switching your machine on but before you start feeding the fruit or vegetables in.
- Remember to peel citrus fruit before juicing.

 - **Thick-skinned fruit and vegetables (e.g. pineapples, mangoes) need to be peeled beforehand and any large pips (e.g. melon) removed. Always remove the stones of stone fruit (e.g. peaches, apricots, cherries). Strip grapes from their stalks before juicing.**

- Some foods are not suitable for processing in a juicer, due to their hard consistency (e.g. coconuts).
- **The J 80 Ultra/J 100 Ultra juicer** features a unique patented Auto Feed system which does away with the need of a pusher.
- To make the best use of your **J 80 Ultra/J 100 Ultra juicer** therefore, introduce the ingredients into the feed tube by hand (without **the pusher**), according to throughput.
- Introduce the pieces of fruit or vegetables slowly and in small quantities.
- When all the ingredients have gone through, leave the machine on for a few more seconds to extract every last drop of juice.
- Never put ice cubes or frozen fruit in the feed tube.

- The pulp may become unevenly distributed inside the basket, creating an imbalance. If your juicer starts to vibrate while juicing, switch it off and clean **the basket**. You can then resume juicing.
- Check that **the flange** and **lid** are correctly positioned.

### • J 80 Ultra

- With **the J 80 Ultra juicer**, you can make several quarts of juice without having to empty **the pulp container**. Nonetheless, remember to check the level of the pulp in the **container** on a regular basis.
- Check that **the flange** and **lid** are correctly fitted.
- Always make sure that **the pulp container** has been properly positioned.

### • J 100 Ultra

#### - J 100 Ultra with pulp container:

You can make several quarts of juice without having to empty **the pulp container**. Nonetheless, you should check the level of pulp in the **container** on a regular basis.

#### - J 100 Ultra with ejection chute:

**The ejection chute** (supplied with your appliance) has been designed specifically to cope with high-volume juicing. With the chute, there is no need to keep on emptying **the pulp container** while juicing.

 - **If you are using your juicer on the edge of a worktop, make sure that all its feet are firmly on the work surface. You must also organize your work station so that there is no risk of the juicer tipping over or falling off.**

**NB:** If you intend to carry out high-volume juicing every day, it is best to use **the continuous pulp ejection chute**, with or without **the booster base**.

## Fruit and vegetable preparation J 80 Ultra • J 100 Ultra

	Preparation
CARROTS	Peeled and left whole, topped and tailed. Feed in 2 or 3 at a time.
APPLES	Washed and left whole (remove stalk and any labels).
STRAWBERRIES	Remove stalks for the taste.
CITRUS FRUIT	Peel all citrus fruit. Oranges and lemons can be left whole.
PINEAPPLES	Peel and cut into eight chunks (3 cuts)
MELONS	Peel and cut into eight chunks.
TOMATOES	Washed and left whole (remove hard green core). Feed in 2 or 3 at a time.
PEPPERS	Washed and cut into quarters lengthwise, according to shape.
CELERIAC	Cut into 6-7 cm chunks
CUCUMBERS	Peeled. Cut into sections measuring approx. 15 cm long.
FENNEL	Cut into 6-7 cm chunks
GINGER	Cut into pieces to make it easier to feed into the juicer. Do not put too many in at a time, to prevent a blockage.
GRAPES	Remove stalks to avoid bitterness.

 **WARNING**  
Always wash fruit and vegetables thoroughly to remove all traces of dirt and pesticides.

## CLEANING

- Always unplug the machine before cleaning of any kind
- To rinse the machine out between two different batches of fruit, switch the machine on and pour a glass of drinking water into the feed tube.



- Clean the basket by scrubbing the outside of the filter cone with a brush or scrubber sponge to remove any pulp.

- For more thorough cleaning, remove the bowl flange beforehand.
- Always clean the entire machine after use, washing the flange, bowl, lid and pusher in hot water. Scrub with a brush using an appropriate detergent.
- To avoid damaging the parts, do not tap them against any hard surfaces.

**\*Tip:** If the pulp has dried hard onto the basket, immerse the basket into hot water for 5-10 minutes to soften it.



## IMPORTANT

Check that your detergent is suitable for use with parts made from plastic or stainless steel. Certain highly alkaline products (e.g. with a high concentration of ammonia or caustic soda) are totally incompatible with some plastics and cause them to deteriorate very quickly.



## IMPORTANT

**Never immerse the motor unit in water or any other liquid and do not spray!**

**Do not clean it with a foam lance or pressure washer.**

**If necessary, wipe the motor unit with a damp cloth.**

**Always unplug your machine first.**

## TECHNICAL SPECIFICATIONS

- **Motor unit** —————> stainless steel
- **Bowl** —————> stainless steel
- **Juicer basket** —————> stainless steel
- **Grating disc** —————> stainless steel
- **Ventilated electric motor** —————> constant speed (3000 rpm)
- **Throughput** —————> **100-120 kg/hour** of fruit or vegetables\* for the **J 80 Ultra**.  
**120-160 kg/hour** for the **J 100 Ultra**.

\* In optimum working conditions, i.e. a suitable worktop, ready prepared fruit and accessories (jug, bin, etc.) all within easy reach.

### • WEIGHT

	Net	Gross
<b>J 80 Ultra</b>	10.9 kg	12.8 kg
<b>J 100 Ultra</b>	12.9 kg	15.6 kg

### • DIMENSIONS (in mm)

#### J 80 Ultra

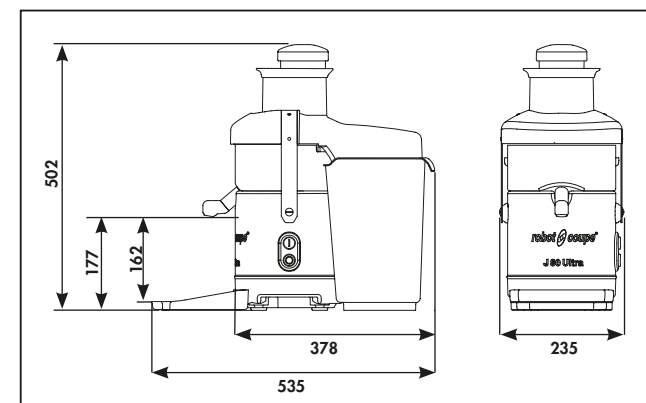

#### J 100 Ultra

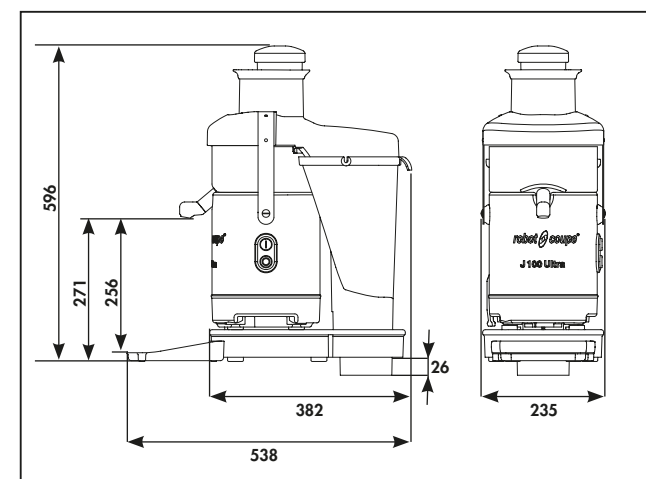

### • WORKING HEIGHT

We advise you to install your **J 80 Ultra/J 100 Ultra centrifugal juicer** on a flat and stable worktop at a suitable height.

### • NOISE LEVEL

The equivalent continuous sound level when the juicer is running empty is below 70 dB (A).



## • ELECTRICAL DATA

### J 80 Ultra

Motor	Speed (rpm)	Intensity (Amp.)
120 V/ 60 Hz	3600	9
220 V/ 60 Hz	3600	6
230 V/ 50 Hz	3000	7

### J 100 Ultra

Motor	Speed (rpm)	Intensity (Amp.)
120 V/ 60 Hz	3600	9
220 V/ 60 Hz	3600	8
230 V/ 50 Hz	3000	8

The power is specified on our data plate.

## SAFETY

- The J 80 Ultra/J 100 Ultra juicer will not start unless the lid has been correctly positioned and the safety arm properly locked into place. The motor will switch itself off as soon as you open the safety arm or press the Off button (red button).
- The J 80 Ultra/J 100 Ultra juicer is equipped with a powerful electric brake which will shut the machine down in less than 2 seconds if you open the safety arm while the juicer is running.
- To switch your juicer back on, simply fold the safety arm back over the lid and press the On button (green button).
- The J 100 Ultra is fitted with a thermal protection system which automatically switches the motor off if it remains overloaded for any length of time. If this happens, wait for the appliance to cool down before resetting the thermal protection (button on underside of the appliance).

- **WARNING:** never use the appliance without either the pulp container or the continuous ejection chute (for the J 100 Ultra).
- Always switch the machine off before removing the pulp container or the continuous pulp ejection chute (for the J 100 Ultra).
- Never insert your hand or any object other than the pusher into the ejector if the machine is plugged in or the basket is rotating.
- Never unplug the appliance by tugging on the power cord or with damp hands.



## REMEMBER

- Never try to override the locking or safety systems.
- Never introduce anything other than fruit or vegetables into the feed tube.
- The lid of your appliance features a unique patented Auto Feed system. Simply introduce the food into the feed tube and let the machine do the rest.
- Should a blockage occur inside the feed tube, NEVER USE any object other than the pusher to clear it. Another solution is to switch the machine off and remove the food causing the problem inside the tube.
- Never use your hand to push the food down into the feed tube.
- Never insert your hand or any object other than the pusher into the ejector if the machine is running or the basket rotating.



## TROUBLESHOOTING

SYMPTOMS	CAUSES AND/OR REMEDIES
The machine will not start	<ul style="list-style-type: none"> <li>- Check the fuses in your mains supply.</li> <li>- Close the safety arm properly</li> </ul> <p><b>J 100 Ultra :</b></p> <ul style="list-style-type: none"> <li>- Check that the thermal protection (button on underside) has been reset.</li> </ul>
Abnormal noise	<ul style="list-style-type: none"> <li>- The appliance has been incorrectly assembled. See "Assembly" chapter.</li> <li>- One of the parts is faulty and needs replacing.</li> </ul>
Inefficient grating	<ul style="list-style-type: none"> <li>- The grating disc is worn. Replace the grating disc inside the basket.</li> <li>- There is a blockage in the feed tube which needs to be cleared.</li> </ul>
The appliance vibrates	<ul style="list-style-type: none"> <li>- The pulp container is full or the basket is out of balance due to an accumulation of pulp on the filter.</li> <li>- If the vibration is permanent, check that the basket has not been damaged in some way.</li> </ul>
The basket does not stop immediately when the safety arm is opened. It takes more than 2 seconds to stop.	<ul style="list-style-type: none"> <li>- Have the appliance checked by a qualified person.</li> </ul>

**IMPORTANT :** For all repairs and maintenance, it is vital to use parts supplied by Robot-Coupe.

## STANDARDS

Consult the declaration of compliance on page 2.

## RECIPES

*Fruit and vegetables can be combined in an infinite number of ways to create exciting, colourful and totally natural drinks. Give your imagination free rein - bearing in mind these few golden rules for making cocktails:*

- *Always use untreated fruit.*
- *Using a shaker will make an opaque mixture more homogeneous.*
- *Fill the lower half of the shaker half-full with ice cubes. Avoid shaking your cocktail for too long, otherwise the ice will melt and spoil it.*

*Here is a selection of cocktail recipes, each for approximately four people.*

### PEACH SPARKLE

#### **Ingredients** (serves 3):

- 6 peaches
- ½ lemon
- 1 generous pinch ground nutmeg
- 300 ml soda water
- 1 thin slice fresh ginger

**Preparation:** stone the peaches and peel the lemon. There is no need to peel the ginger. Process the peaches in your J 80 Ultra/J 100 Ultra juicer first, followed by the ginger, then the lemon.

Next, combine the ground nutmeg and soda water with the juice. Divide between three glasses.

**Garnish:** *decorate the glasses with thin slices of peach.*

**Idea:** *you can use either white or yellow peaches for this juice.*

### HONEYED WATERMELON

#### **Ingredients** (serves 3):

- 750 g watermelon
- ½ lemon
- 20 g honey
- 20 g water

**Preparation:** boil the honey and water together and allow to cool. Remove the watermelon rind and pips and cut the flesh into large chunks. Peel the lemon.

Process the fruit in your J 80 Ultra/J 100 Ultra juicer.

Pour the honey mixture into the glasses first, followed by the watermelon juice.

**Garnish:** *serve with thinly sliced watermelon.*

### CARROT CAPRICE

#### **Ingredients** (serves 4):

- 4 carrots
- 4 oranges
- 1 thin slice fresh ginger
- Ice cubes

**Preparation:** wash and scrub the carrots (no need to peel them). Peel the oranges. Process all the ingredients except for the ice cubes in your J 80 Ultra/J 100 Ultra juicer.

Divide between four glasses, add the ice cubes and serve immediately.

**Garnish:** *decorate with an olive and a slice of orange.*

## CUCUMBER QUENCHER

#### **Ingredients** (serves 4):

- 1 cucumber
- 4 Granny Smith apples
- 3 tbsp dill
- ½ lemon
- Goat's milk

**Preparation:** wash the cucumber but do not peel it, as the skin contains vitamins and will also lend color to your cocktail. For this reason, use an organic cucumber, if possible. Peel the lemon.

Process the cucumber, apples and dill in your J 80 Ultra /J 100 Ultra juicer, followed by the lemon. Combine the goat's milk with the juice.

**Garnish:** *decorate with radishes sliced in your Robot-Coupe veg prep machine (1 mm slicer disc).*

### PRETTY PINK

#### **Ingredients** (serves 4):

- 300 g strawberries
- 3 carrots
- ¼ pineapple

**Preparation:** peel the pineapple and cut into chunks. You do not need to hull the strawberries, as their stalks will automatically be ejected into the pulp container.

Process the pineapple, strawberries and carrots in your J 80 Ultra/J 100 Ultra juicer in that order. Stir well and divide between glasses decorated with sliced strawberries.

**Idea:** *liven up your cocktail with a pinch of ground vanilla bean, cardamom or ginger.*



## APPLE-KIWI

### **Ingredients** (serves 3):

- 3 Granny Smith apples
- ½ lime
- 3 kiwi fruit

**Preparation:** peel the lime. Peel the kiwis so that the cocktail retains a good green color. Process all the ingredients in your J80 Ultra/J100 Ultra juicer.

Stir with a spoon and serve immediately, before the apple starts to go brown

**Idea:** if you find the taste too acidic, simply add a little honey or cane sugar syrup. You can also replace the kiwi fruit with a cucumber or a stick of celery

## MELLOW GRAPEFRUIT

### **Ingredients** (serves 3):

- 250 g orange
- 250 g grapefruit
- 250 g strawberries

**Preparation:** peel the oranges and grapefruit to avoid a bitter taste. Process all the ingredients in your J80 Ultra/J100 Ultra juicer.

Stir well and divide between the glasses.

**Idea:** if you find the juice too acidic, simply add a little honey or cane syrup.

## ORIENTAL

### **Ingredients** (serves 3):

- ½ pineapple
- 3 oranges
- 1 tsp vanilla extract

**Preparation:** peel the fruit. Process the pineapple in your J80 Ultra/J100 Ultra juicer first, followed by the oranges.

Stir the vanilla extract into the juice and serve in small shot glasses.

**Idea:** replace the oranges with coconut milk.

## CLASSIC

### **Ingredients** (serves 3):

- 4 carrots
- 3 apples
- 1 lemon

**Preparation:** peel the lemon. Wash and scrub the carrots (no need to peel them). Process all the ingredients in your J80 Ultra/J100 Ultra juicer.

Stir well and serve.

**Idea:** you can substitute pears for the apples.

## GAZPACHO

### **Ingredients** (serves 3):

- 500 g ripe tomatoes
- ½ small red pepper
- ½ cucumber
- ½ small stick celery
- 1 tbsp olive oil
- Drop of sherry vinegar
- Salt
- Pepper

**Preparation:** process all the vegetables in your J80 Ultra/J100 Ultra juicer, then add the olive oil, sherry vinegar and salt.

**Garnish:** decorate with a twist of lemon peel and a slice of tomato.

**Idea:** as tomato opens the appetite, serve the gazpacho at the start of the meal.

## MELON MELODY

### **Ingredients** (serves 3):

- 400 g green-skinned melon
- 1 Granny Smith apple
- ½ lemon

**Preparation:** remove the melon rind and pips and cut the flesh into large chunks. Peel the lemon. Process all the ingredients in your J80 Ultra/J100 Ultra juicer.

Stir with a spoon and serve immediately, flavored with a few mint leaves.

**Garnish:** Garnish: decorate with melon diced in your Robot-Coupe veg prep machine (5 x 5 x 5 mm dicing attachment).

**Idea:** replace the melon with watermelon.

## MELON-PEAR WITH TURMERIC

### **Ingredients** (serves 4):

- 1400 g yellow honeydew melon
- 1 grapefruit
- ½ pear
- ½ Golden Delicious apple
- 1 thin slice fresh ginger
- ½ lemon grass stalk
- 1 tiny pinch turmeric

**Preparation:** peel the melon and grapefruit. Process the apple, ginger, lemon grass, pear, melon and grapefruit in your J80 Ultra/J100 Ultra juicer in that order. Stir well and divide between four glasses.

**Garnish:** decorate the glasses with pear sliced in your Robot-Coupe veg prep machine (1 mm slicer disc).

## APPLE-CELERY

---

### **Ingredients** (serves 4):

- 4 *Granny Smith apples*
- 2 *sticks celery*
- 1 *thin slice fresh ginger*
- ½ *lemon*
- *Salt*

**Preparation:** wash the celery sticks thoroughly and process in your J 80 Ultra/J 100 Ultra juicer, followed by the ginger, then the apples. Season with a little salt and serve immediately, before the apple starts to go brown.

**Garnish:** *decorate the glasses with apple sliced in your Robot-Coupe veg prep machine (1 mm slicer disc).*

**Idea:** *you can use pears instead of apples.*

## SCARLET COCKTAIL

---

### **Ingredients** (serves 4):

- 1 *cooked beetroot*
- 2 *carrots*
- 2 *small bunches red grapes*
- 2 *Granny Smith apples*
- *Cayenne pepper*

**Preparation:** process all the fruit and vegetables in your J 80 Ultra/J 100 Ultra juicer.

Season the juice with Cayenne pepper and serve chilled.

**Garnish:** *decorate each glass with a slice of baby beetroot.*

## ASPARAGUS SPEARS

---

### **Ingredients** (serves 3):

- 1 *kg green asparagus*
- 1 *pinch ground Espelette pepper*
- 1 *pinch fleur de sel sea salt*

**Preparation:** peel the asparagus spears and discard the tough ends of the stalks.

Process in your J 80 Ultra/J 100 Ultra juicer.

Season with a little Espelette pepper and sea salt.

**Idea:** *use this cocktail to accompany a salmon dish.*

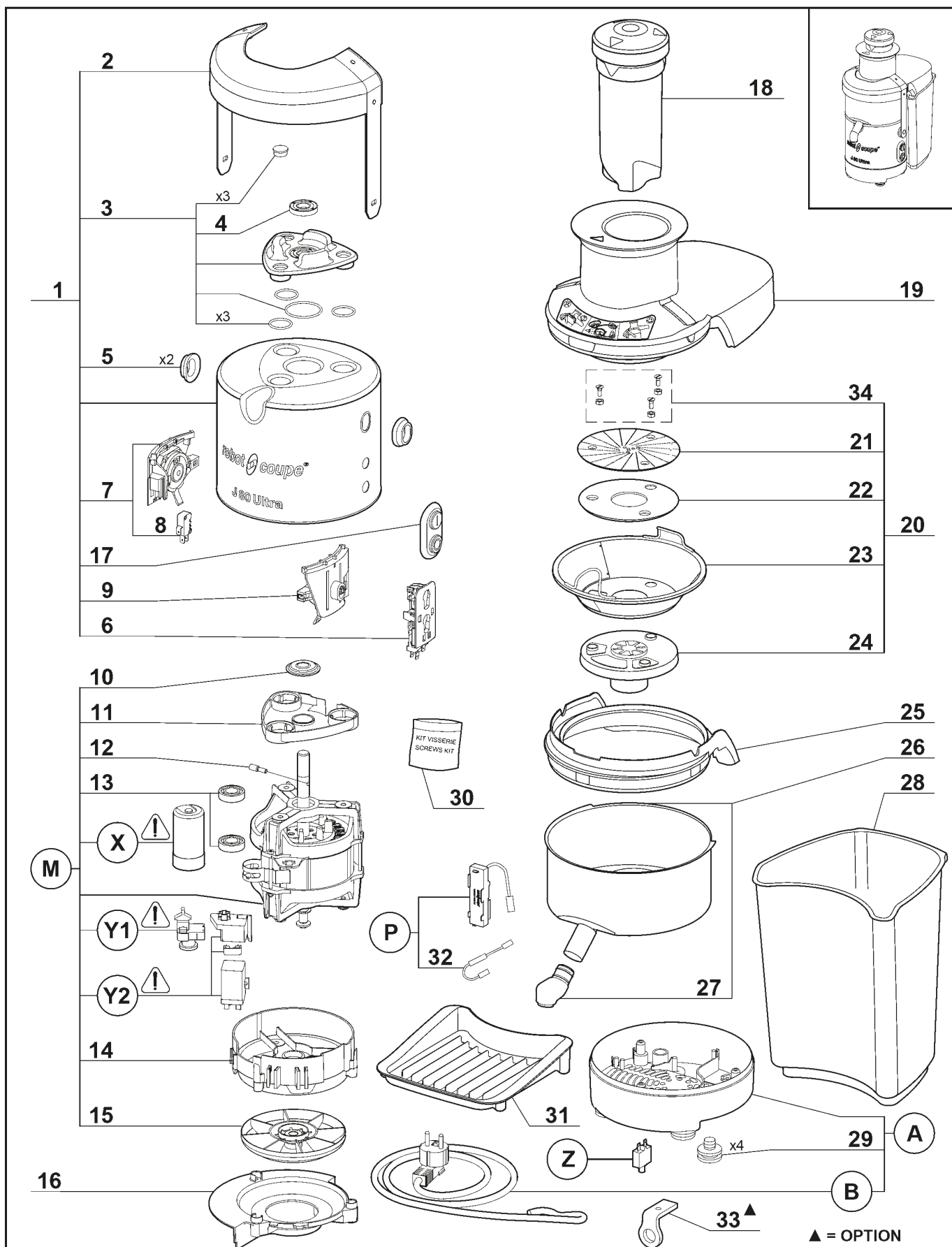
**robotcoupe®****J 80 Ultra**N° de série / Serial number  
- 520 - - - - -

RECOMMANDATION : Il est préconisé de remplacer simultanément le relais Y et le condensateur X  
 RECOMMENDATION: It's recommended to replace simultaneously both relay Y and capacitor X

Maj : 11/2017

REV : j

Index	Pièce / Part	Désignation	Description
1	39 895	ENS. SUPPORT MOTEUR	MOTOR SUPPORT ASSEMBLY
2	39 896	LEVIER DE BLOCAGE	LOCKING LEVER
3	39 897	ENS. CENTRAGE DE CUVE	BOWL CENTRING
4	501 010S	BAGUE D'ETANCHEITE	SHAFT SEAL
5	39 898	CACHE PALIER (Qté = 2)	BEARING CACHE (Qty = 2)
6	39 899	ENS. BLOC MARCHE/ARRET	ON/OFF BLOCK ASSEMBLY
7	39 900	ENS. PALIER GAUCHE	LEFT BEARING ASSEMBLY
8	507 007S	INTERRUPTEUR	SWITCH
9	39 901	ENS. PALIER DROIT	RIGHT BEARING ASSEMBLY
10	39 902	DEFLECTEUR D'AXE	SHAFT DEFLECTOR
11	39 903	CENTRAGE MOTEUR	MOTOR CENTRING
12	49 155	GOUPILLE	MOTOR SHAFT PIN
13	39 905	ENS. ROULEMENTS	BALL BEARINGS KIT
14	39 906	CONDUIT DE VENTILATION	BAFFLE
15	118 512S	VENTILATEUR MOTEUR	MOTOR FAN
16	39 907	DEFLECTEUR MOTEUR	MOTOR DEFLECTOR
17	39 927	ENS. TABLEAU COMMANDE	CONTROL PANEL ASSEMBLY
18	39 283	POUSOIR	PUSHER
19	39 909	COUVERCLE	LID
20	39 910	ENS. PANIER	BASKET ASSEMBLY
21	39 911	DISQUE RAPEUR (INCLUANT LES VIS)	GRATER (INCLUDING SCREWS)
22	39 929	RONDELLE INCLINEE (INCLUANT LES VIS)	ANGLED SPACER (INCLUDING SCREWS)
23	39 912	FILTRE (INCLUANT LES VIS)	SIEVE (INCLUDING SCREWS)
24	39 913	MOYEU (INCLUANT VIS ET ECROUS)	HUB (INCLUDING NUTS AND SCREWS)
25	39 914	COLLERETTE DE CUVE	BOWL FLANGE
26	39 915	CUVE	BOWL
27	39 916	BEC VERSEUR	SPOUT
28	39 917	COLLECTEUR DE PULPE	PULP COLLECTOR
29	39 928	PIEDS (Qté = 4)	FEET (Qty = 4)
30	39 960	KIT VISSERIE (incluant toutes les vis du bloc moteur)	SCREWS KIT (including all screws for the motor base)
31	39 516	RAMASSE GOUTTES	DRIP TRAY
32	49 180	RESISTANCE	RESISTOR
33	39 986	OPTION : KIT ANTIVOL	OPTION: ANTI-THEFT KIT
34	49 158	KIT VIS + ECROUS POUR PANIER	KIT SCREWS + NUTS FOR BASKET

Index	Désignation	Description
<b>A</b>	ENS. SOCLE	BASE ASSEMBLY
<b>B</b>	CABLE D'ALIMENTATION	POWER CORD
<b>M</b>	MOTEUR	MOTOR
<b>P</b>	MODULE DE FREINAGE	BRAKING MODULE
<b>X</b>	CONDENSATEUR	CAPACITOR
<b>Y1 - Y2</b>	RELAIS DE DEMARRAGE MOTEUR	MOTOR STARTING RELAY
<b>Z</b>	COUPE-CIRCUIT	CIRCUIT BREAKER

Machine	Voltage	A	B	M	P	X	Y1	Y2	Z
56 000A	230/50/1	39 919	39 888	39 926	39 585	600 018S	500 289S	-	-
56 001A UK		39 922	39 889						
56 020A ZA		39 595	39 597						
56 006A CH		39 920	39 893						
56 007A DK		39 921	39 892						
56 002A AA	240/50/1	39 923	39 891	39 925	39 586	600 089S	504 674S	-	-
56 030A CN	220/50/1	39 721	39 229						
56 004A	220/60/1	39 919	39 888						
56 010A SA		39 922	39 889						
56 011A BR		39 593	39 594						
56 005A	120/60/1	39 918	39 890	39 924	39 586	600 089S	500 296S	-	39 588
56 015A TW		39 722	39 245	39 499			-		

robotcoupe®

J 100 Ultra

N° de série / Serial number  
 - 602 - - - - - 713 - - - - -  
 - 703 - - - - -

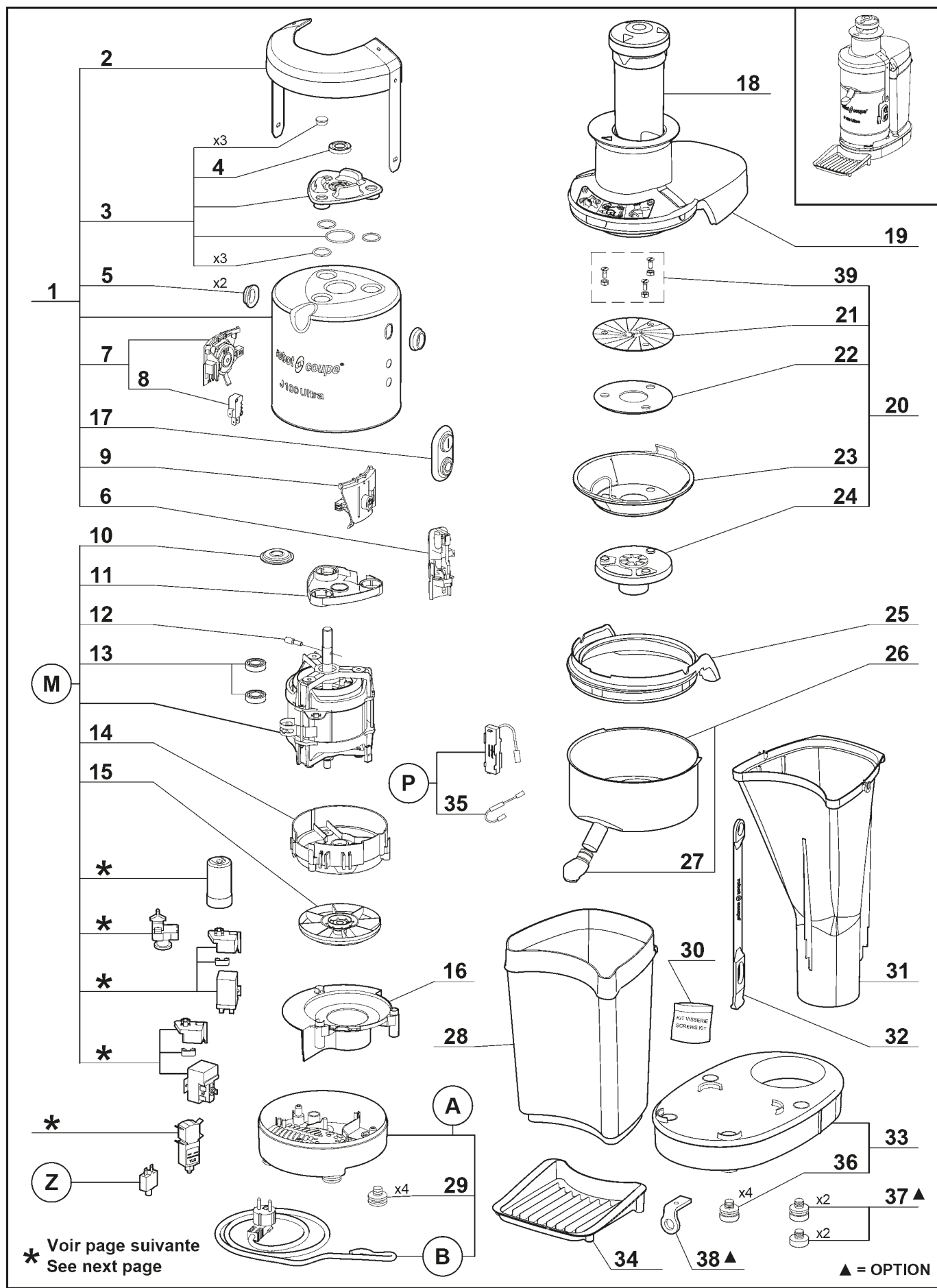

**\***

**RELAIS - CONDENSATEUR - COUPE-CIRCUIT 2 POLES**  
**RELAY - CAPACITOR - 2 POLES CIRCUIT BREAKER**

RECOMMANDATION : Il est préconisé de remplacer simultanément le relais Y et le condensateur X  
 RECOMMENDATION: It's recommended to replace simultaneously both relay Y and capacitor X

**ETAPE**  
**STEP 1** Identifier la couleur du fil  
 Identify the wire color

**ETAPE**  
**STEP 2** Choisir la pièce à commander  
 (selon forme relais)  
 Choose the part to be ordered  
 (according to relay shape)

Cosse "Drapeau"  
 "Flag" Terminal

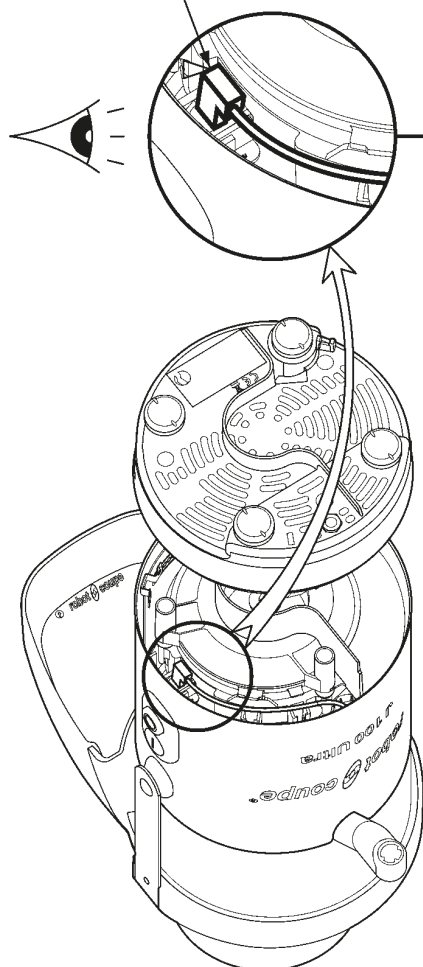

**FIL NOIR /**  
**BLACK WIRE**

**FIL BLEU /**  
**BLUE WIRE**

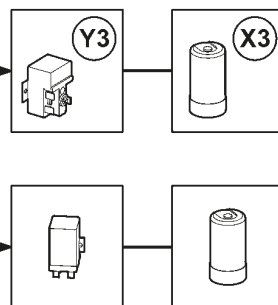
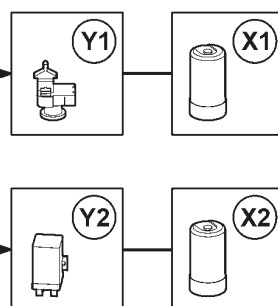

**NECESSITE KIT DE MISE A NIVEAU**  
**REQUIRES UPGRADE KIT**

**(W)**

**(\*)** Seulement 50 Hz  
 50 Hz only

Index	Pièce / Part	Désignation	Description
1	39 512	ENS. SUPPORT MOTEUR	MOTOR SUPPORT ASSEMBLY
2	39 896	LEVIER DE BLOCAGE	LOCKING LEVER
3	39 897	ENS. CENTRAGE DE CUVE	BOWL CENTRING
4	501 010S	BAGUE D'ETANCHEITE	SHAFT SEAL
5	39 898	CACHE PALIER (Qté = 2)	BEARING CACHE (Qty = 2)
6	39 988	ENS. BLOC MARCHE/ARRET	ON/OFF BLOCK ASSEMBLY
7	39 900	ENS. PALIER GAUCHE	LEFT BEARING ASSEMBLY
8	507 007S	INTERRUPTEUR	SWITCH
9	39 901	ENS. PALIER DROIT	RIGHT BEARING ASSEMBLY
10	39 902	DEFLECTEUR D'AXE	SHAFT DEFLECTOR
11	39 903	CENTRAGE MOTEUR	MOTOR CENTRING
12	49 155	GOUPILLE	MOTOR SHAFT PIN
13	39 905	ENS. ROULEMENTS	BALL BEARINGS KIT
14	39 906	CONDUIT DE VENTILATION	BAFFLE
15	118 512S	VENTILATEUR MOTEUR	MOTOR FAN
16	39 509	DEFLECTEUR MOTEUR	MOTOR DEFLECTOR
17	39 927	ENS. TABLEAU COMMANDE	CONTROL PANEL ASSEMBLY
18	39 283	POUSOIR	PUSHER
19	39 909	COUVERCLE	LID
20	49 057	ENS. PANIER USAGE INTENSIF	BASKET ASSEMBLY HEAVY DUTY
21	49 048	DISQUE RAPEUR USAGE INTENSIF (INCLUANT LES VIS)	GRATER HEAVY DUTY (INCLUDING SCREWS)
22	39 929	RONDELLE INCLINEE (INCLUANT LES VIS)	ANGLED SPACER (INCLUDING SCREWS)
23	39 912	FILTRE (INCLUANT LES VIS)	SIEVE (INCLUDING SCREWS)
24	39 913	MOYEU (INCLUANT VIS ET ECROUS)	HUB (INCLUDING NUTS AND SCREWS)
25	39 914	COLLERETTE DE CUVE	BOWL FLANGE
26	39 915	CUVE	BOWL
27	39 916	BEC VERSEUR	SPOUT
28	39 513	COLLECTEUR DE PULPE	PULP COLLECTOR
29	39 928	PIEDS (Qté = 4)	FEET (Qty = 4)
30	39 514	KIT VISSERIE (incluant toutes les vis du bloc moteur)	SCREWS KIT (including all screws for the motor base)
31	39 522	GOULOTTE D'EJECTION CONTINUE	CONTINUOUS PULP EJECTION CONDUIT
32	39 510	SANGLE	STRAP
33	39 515	SUPPORT DE MACHINE	MACHINE BASE
34	39 516	RAMASSE GOUTES	DRIP TRAY
35	49 180	RESISTANCE	RESISTOR
36	39 833	PIEDS DE SUPPORT DE MACHINE (Qté = 4)	MACHINE BASE FEET (Qty = 4)
37	49 171	OPTION : PIED D'INCLINAISON (Support de machine)	OPTION: TILTING FOOT (For machine base)
38	39 986	OPTION : KIT ANTIVOL	OPTION: ANTI-THEFT KIT
39	49 158	KIT VIS + ECROUS POUR PANIER	KIT SCREWS + NUTS FOR BASKET



# J 80 Ultra - J 100 Ultra

Français	English	Español	Deutsch
CD Condensateur de démarrage	Starting capacitor	Condensador d'arranque	Anlasskondensator
DT Coupe-circuit *	Circuit breaker *	Disyuntor *	Ausschalter *
EA Phase auxiliaire	Starting phase	Fase auxiliar	Hilfsphase
EP Phase principale	Main phase	Fase principal	Hauptphase
KD Relais de démarrage	Starting relay	Rele d'arranque	Anlassrelais
MA Interrupteur MARCHÉ / ARRÊT	ON / OFF switch	Interruptor MARCHA / PARADA	Stop / Betriebsschalter
MF Module de freinage	Braking module	Módulo de frenado	Bremsmodul
MO Moteur monophasé	Single phase Motor	Motor monofásico	Motor einphasig
PTO Protecteur thermique du moteur	Motor thermal protector	Protector termico del motor	Motorthermoschutz
R Résistance 1 Ohm 6 W	Resistor 1 Ohm 6 W	Resistencia 1 ohmio 6 W	Widerstand 1 Ohm 6 W
SW Interrupteur sécurité étrier	Clamp safety switch	Interruptor de seguridad cojinete	Stoßbügel zur Decksicherheit

\* N'est pas utilisé sur tous les modèles - Is not used on all models  
No utilizado con todos modelos - Ist nicht bei allen Modellen verwendet

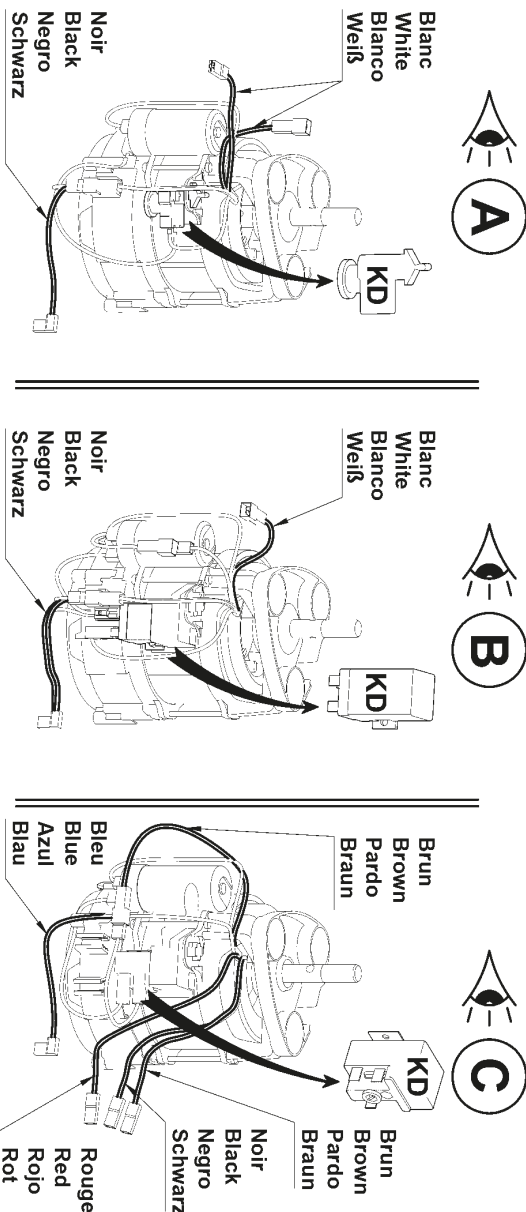

rouge / red / rojo / rot → 120V/60Hz  
violet / purple / púrpura / violet → 220V/60Hz  
blanc / white / blanco / weiß → 230V/50Hz

TENSION MOTEUR MOTOR VOLTAGE TENSION DEL MOTOR MOTOR SPANNUNG	CD	KD
J80 Ultra 120V/60Hz	315µF/120V	MTRPH 0016-39
220V/60Hz	60µF/250V	MTRPH 52-39
J100 Ultra 230-240V/50Hz	100µF/250V	MTRPH 52-39
220V/60Hz		

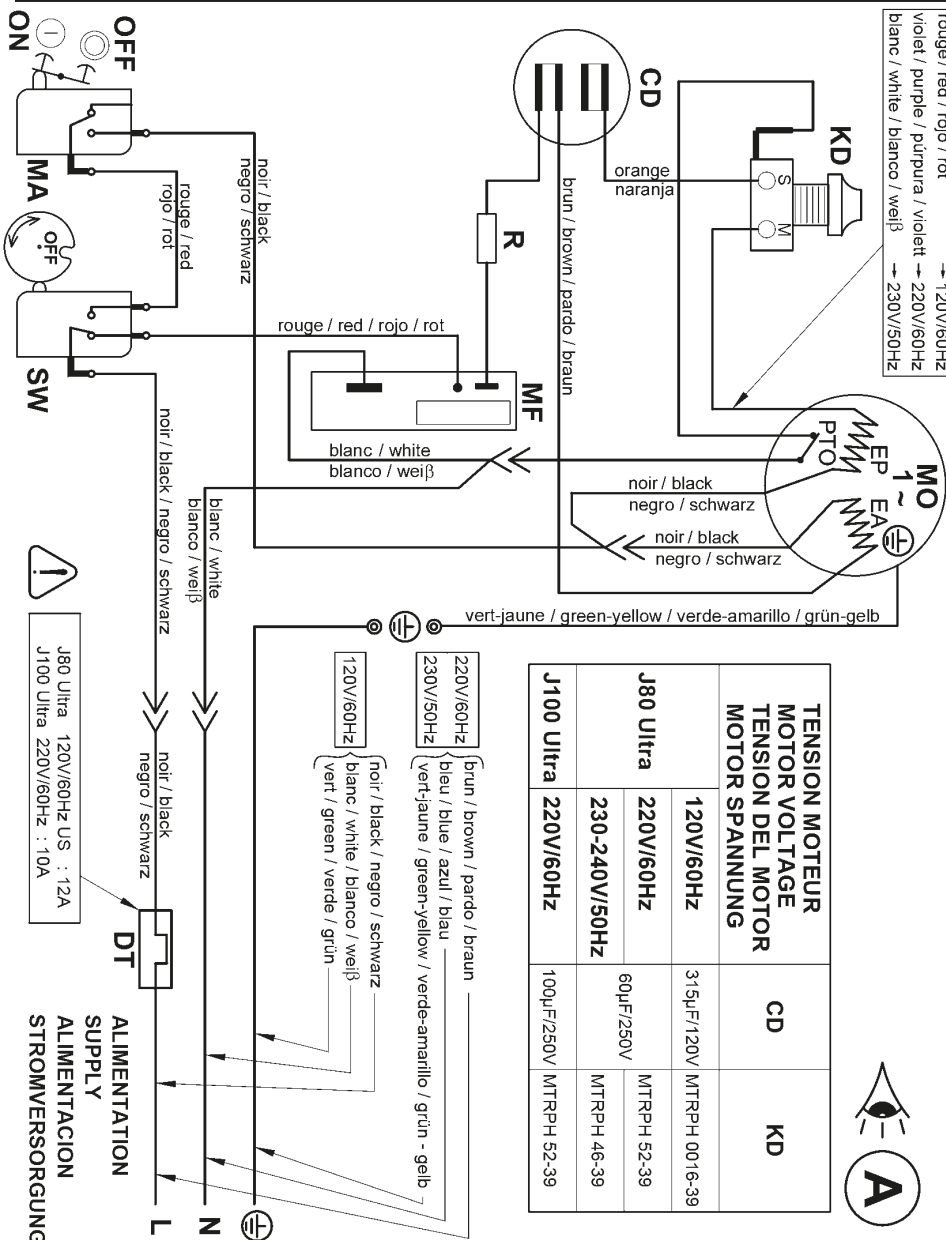

robot coupe®

N° 400228 1/2 (d)

Maj : 01/16

## J 80 Ultra - J 100 Ultra

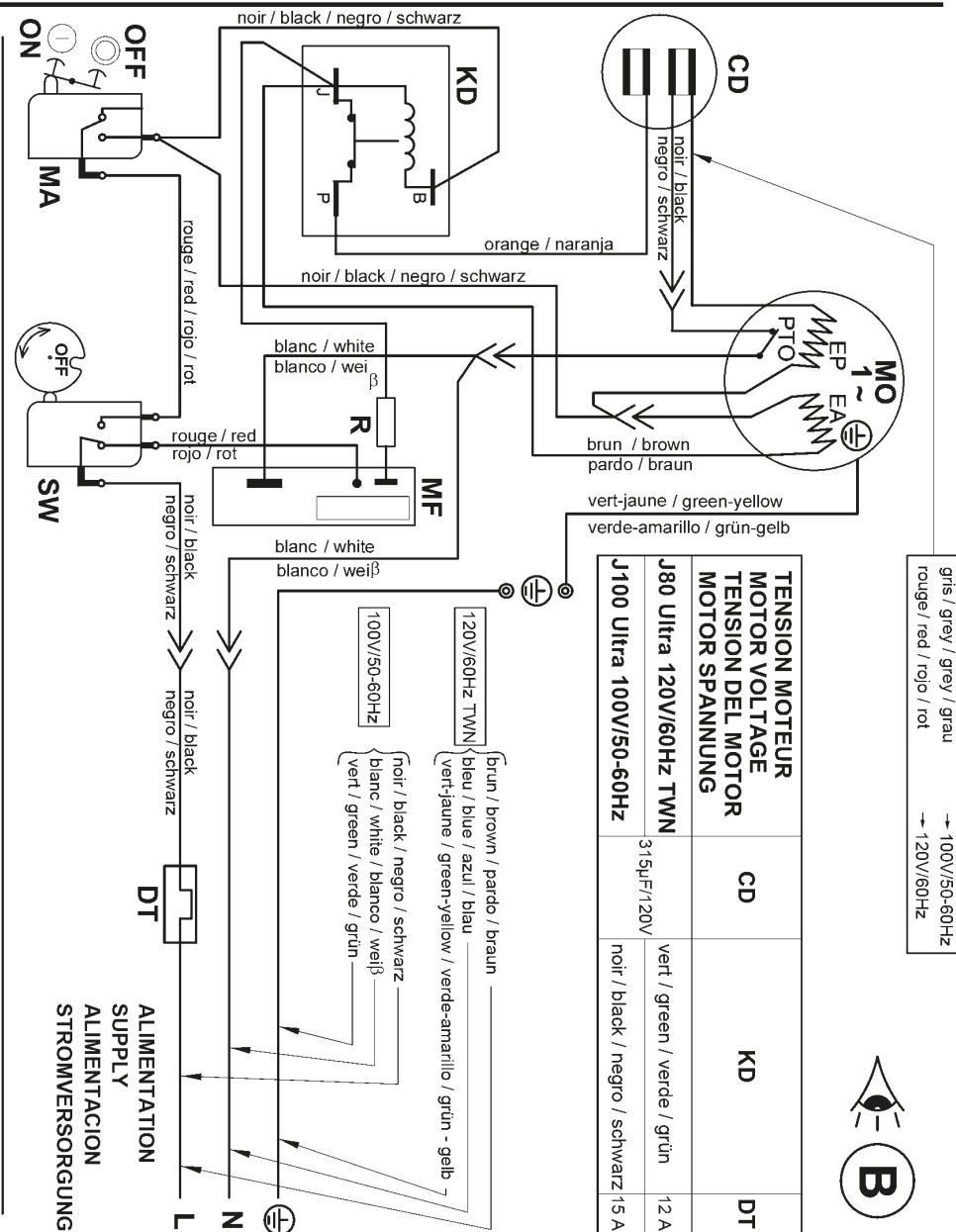

TENSION MOTEUR MOTOR VOLTAGE TENSION DEL MOTOR MOTOR SPANNUNG	CD	KD	DT
J100 Ultra	120V/60Hz	160µF/120V	KLIXON 4CR2 - 785 12 A
	230-240V/50Hz	40µF/280V	KLIXON 4CR2 - 728 10 A

\*Cosses non connectées avec cette version de relais de démarrage  
Terminals not connected with this version of starting relay  
Tomadas no conectadas con esta versión de relés de arranque  
Die Flaschsteckhülse werden nicht mit diese Relais Version angeschlossen

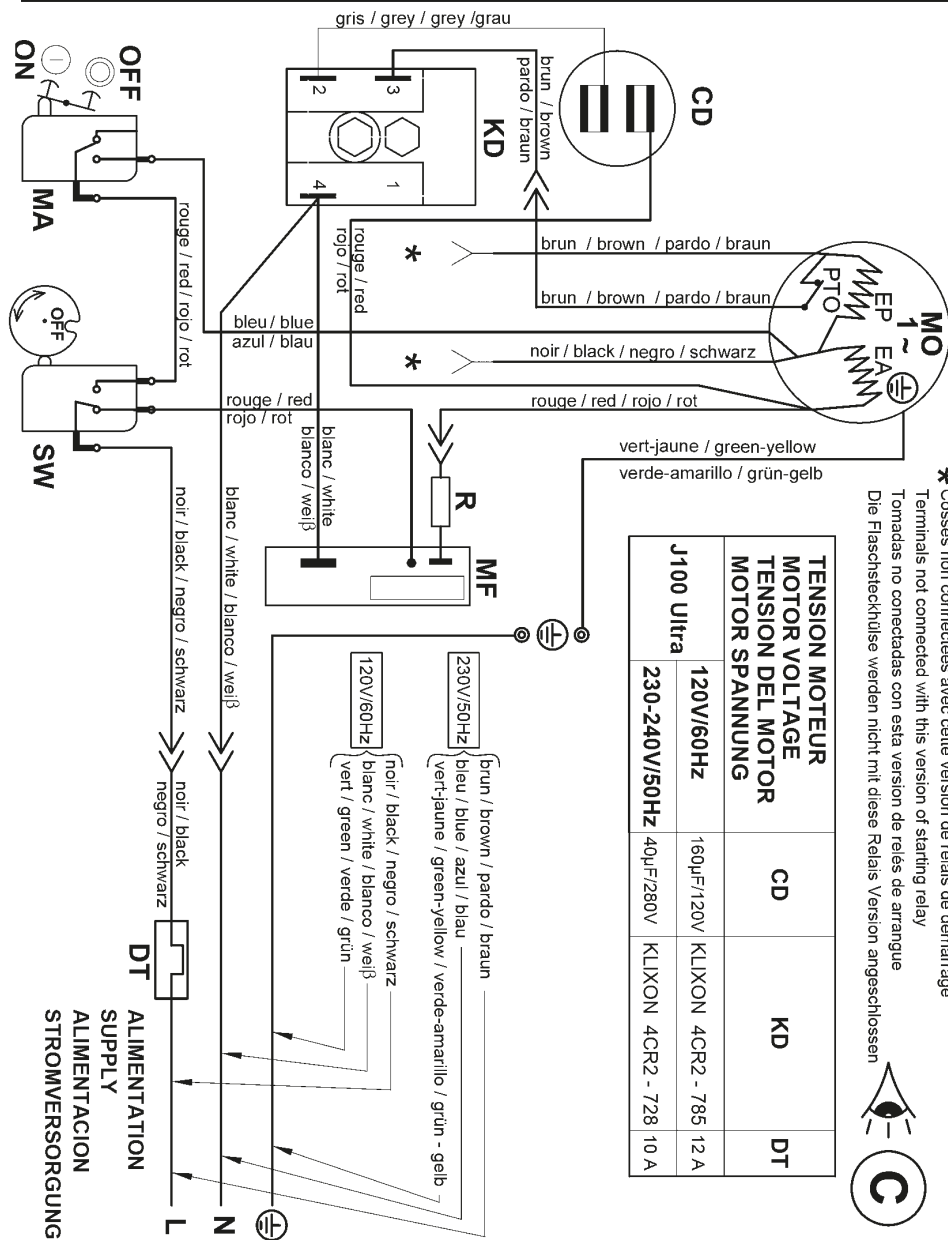

**1**

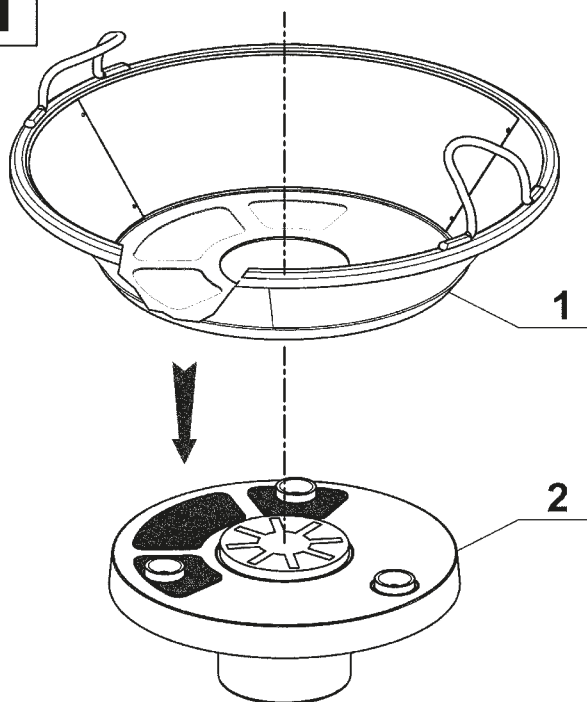

**2**

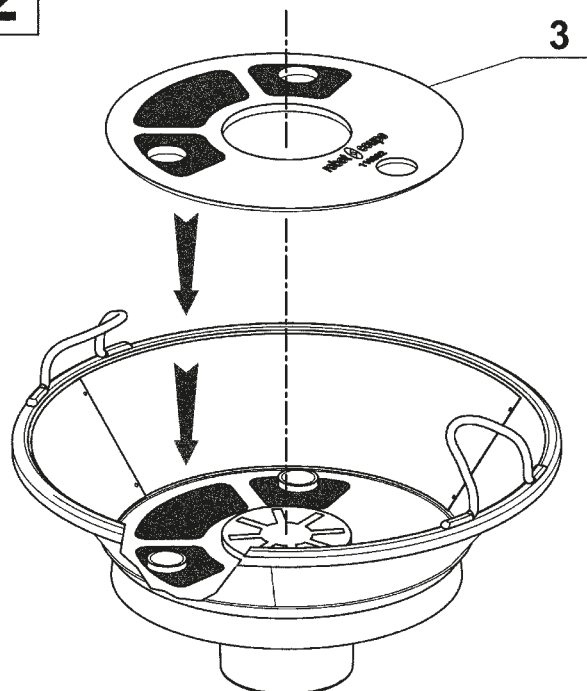

**3**



**A aligner  
To align**

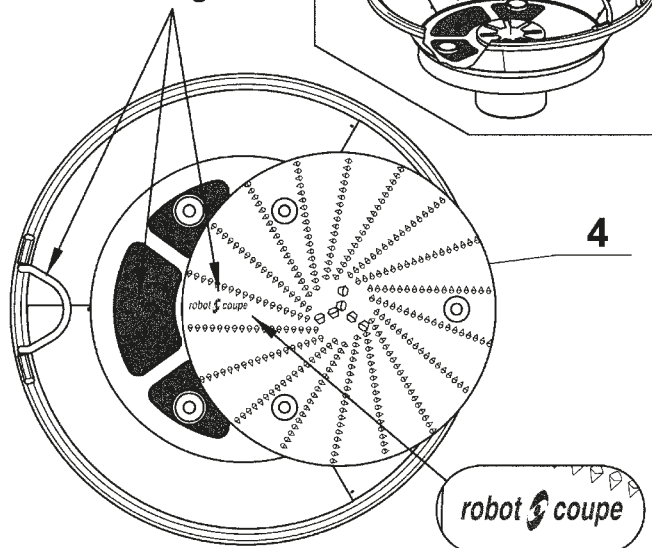

**4**



**VERIFIER LA FORME DU MOYEU  
CHECK THE HUB SHAPE**

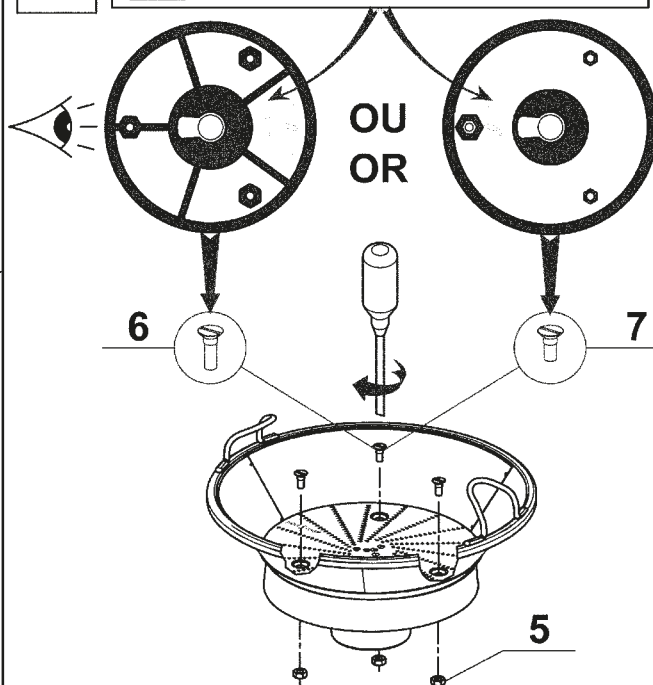

Index	Pièce / Part	Désignation	Description	Quantité / Quantity
1	39 912	FILTRE	SIEVE	1
2	39 913	MOYEU	HUB	1
3	39 929	RONDELLE INCLINEE	ANGLED SPACER	1
4	39 911	DISQUE RAPEUR	GRATER	1
5	206 162	ECROU HM4 INOX	NUT HM4 (Stainless Steel)	3
6	200 123	VIS F M4x12 INOX	SCREW M4x12 (Stainless Steel)	3
7	206 972	VIS F M4x10 INOX	SCREW M4x10 (Stainless Steel)	3



**robot coupe®**

**Head Office, French,  
Export and Marketing Department:**  
48, rue des Vignerons  
94305 Vincennes Cedex- France  
Tel.: 01 43 98 88 15 - Fax: 01 43 74 36 26  
Email: [international@robot-coupe.com](mailto:international@robot-coupe.com)

**Robot Coupe Australia Pty Ltd:**  
Unit 3/43 Herbert St  
Artarmon NSW 2064 Australia  
Tel.: (02) 9478 0300  
Fax (02) 9460 7972  
Email: [orders@robotcoupe.com.au](mailto:orders@robotcoupe.com.au)

**Robot-Coupe U.K. LTD:**  
Fleming Way, Isleworth,  
Middlesex TW7 6EU  
Tel.: 020 8232 1800  
Fax: 020 8568 4966  
Email: [sales@robotcoupe.co.uk](mailto:sales@robotcoupe.co.uk)